

QCI5050X

High Power, High Isolation

Features:

- * High Power
- * High Isolation
- * Low Insertion Loss
- * Low VSWR

Applications:

- * Wireless
- * Radar
- * Laboratory Test

Description

QC15050X series Coaxial Isolators cover frequency range 260–330MHz. High power, high isolation and low insertion loss make it ideal for a lot of applications like amplifiers, transceivers, etc.

Specifications

Frequency (MHz)	Bandwidth (MHz)	IL (dB Max.)	Isolation (dB Min.)	VSWR (Max.)	Fwd Power (W Max.)	Rev Power (W)	Connector	Temperature (°C)
260~330	70	0.80	15.0	1.50	500	20	N	-30~+70

Outline Drawings

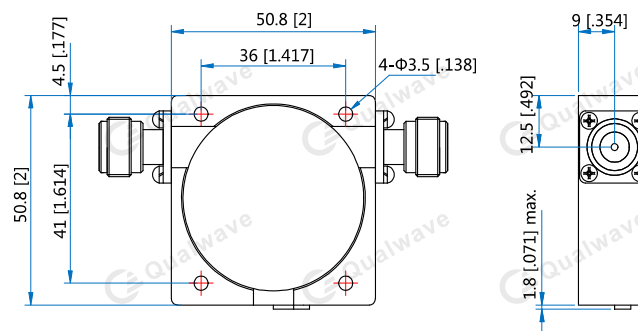

Unit: mm [inch] Tolerance: ±0.2mm [±0.008in]

Mechanical

Size*2: 50.8*50.8*9mm
2*2*0.354in

Mounting: 4- Φ 3.5mm through-hole

[2] Exclude connectors and terminations.

Connector Naming Rules:

N - N Female

Direction Naming Rules:

1 - Clockwise
2 - Anticlockwise

How To Order

QCI5050X-U-V-W-X-Y-Z

U: Start frequency in MHz

V: Stop frequency in MHz

W: Forward power in W

X: Reverse power in W

Y: Connector type

Z: Direction type

Examples:

To order a QCI5050X series Isolator, 260–330MHz, Forward power 500W, Reverse power 20W, N female, Clockwise, specify QCI5050X-260-330-K5-20-N-1.

Customization is available upon request.