

## QCPF-MO-M38-01

### SMP Connector, DC~40GHz

Features:  
\* Low VSWR

Applications:  
\* Wireless  
\* Radar  
\* Instruments  
\* Electronics

#### Electrical

Frequency:	DC~40GHz
VSWR:	1.10 max. @DC~10GHz 1.20 max. @10~26.5GHz 1.25 max. @26.5~40GHz
Impedance:	50Ω
Impedance of Dielectric:	1000MΩ (250V)
Voltage Withstand:	500V AC

#### Mechanical

RF Connector:	SMP male
Detent mode:	Full detent
Bead:	7070 glass sintering
Outer Conductor:	Gold plated keval 4J29
Inner Conductor:	Gold plated keval 4J29

#### How To Order

**QCPF-MO-M38-01**

Customization is available upon request.

#### Outline Drawings

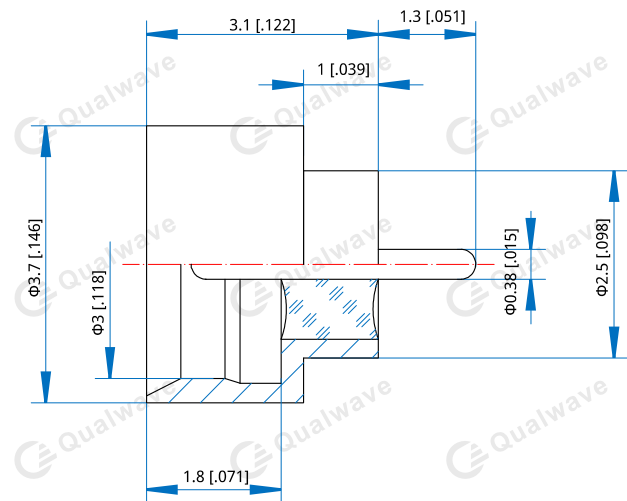

Unit: mm [in]

Tolerance:  $\pm 0.05\text{mm}$  [ $\pm 0.002\text{in}$ ]