

QWTR-51-42

WR-51 to WR-42

Features:
 * Low VSWR
 * High Isolation

Applications:
 * Wireless
 * Transmitter
 * Laboratory Test
 * Radar

Electrical

Frequency: 17.6–22GHz
 VSWR: 1.15 max.
 Insertion Loss: 0.1dB max.

Mechanical

Waveguide Size & Flange: WR-51 (BJ180) with FBP180
 Waveguide Size & Flange: WR-42 (BJ220) with FBP220
 Material: Aluminium
 Finishing: Conductive oxidatio
 Coating: Black paint

Outline Drawings

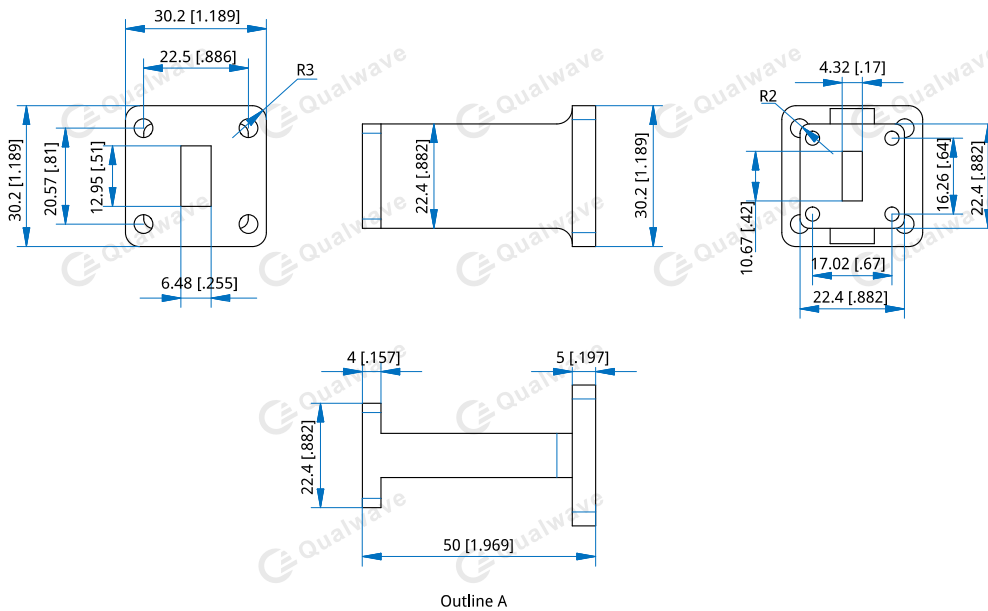

Unit: mm [in]
 Tolerance: $\pm 0.2\text{mm}$ [$\pm 0.008\text{in}$]

How To Order

QWTR-51-42-W-X-Y

W: Length
 X: Material
 Y: Flange type

Length in mm.
 50 - 50mm (Outline A)

Material naming rules:
 A - Aluminium (Outline A)

Flange naming rules:
 1-1 - FBP180-FBP220 (Outline A)

Examples:
 To order a Waveguide Transition, WR-51 to WR-42, 50mm, Aluminium, FBP180-FBP220, specify QWTR-51-42-50-A-1-1.

Customization is available upon request.