

# QWPD2-18000-26500-K15-42

## 2-Way, 18~26.5GHz, 150W, WR-42

Features:  
 \* Small Size  
 \* Low Insertion Loss

Applications:  
 \* Amplifiers  
 \* Mixers  
 \* Antennas  
 \* Laboratory Test

### Electrical

Frequency:	18~26.5GHz
Insertion Loss:	0.25dB max.
VSWR:	1.15 max.
Phase Balance:	±3°
Power @SUM Port:	150W as divider 150W as combiner

### Mechanical

Waveguide Size:	WR-42 (BJ220)
Flange:	FBP220
Material:	Aluminium
Finish:	Conductive oxidation
Coating:	Black paint

### Environmental

Operating Temperature: -55~+85°C

### How To Order

**QWPD2-18000-26500-K15-42-Y-Z**

Y: Material

Z: Flange type

Material naming rules:

A - Aluminium (Outline A)

Flange naming rules:

1 - FBP (Outline A)

Examples:

To order a 2-way waveguide power divider, 18~26.5GHz, 150W, WR-42, Aluminium, FBP220, specify QWPD2-18000-26500-K15-42-A-1.

Customization is available upon request.

### Outline Drawings

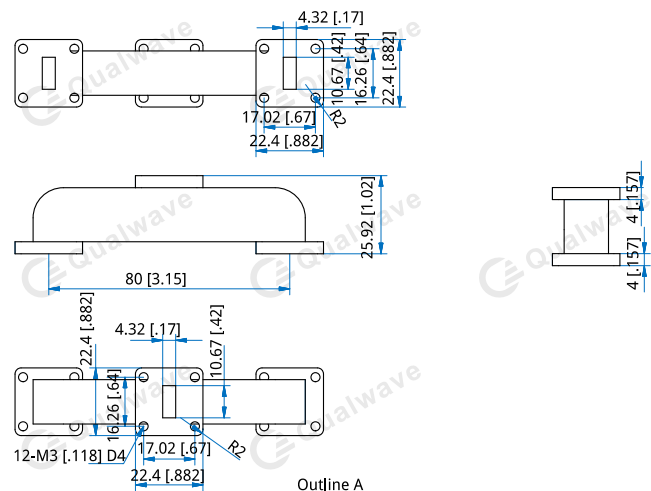

Unit: mm [in]

Tolerance: ±0.5mm [±0.02in]