

## QWB-90 WR-90

Features:  
\* Low VSWR  
\* High Isolation

Applications:  
\* Wireless  
\* Transmitter  
\* Laboratory Test  
\* Radar

### Electrical

Frequency: 8.2~12.5GHz  
VSWR: 1.1 max.  
Insertion loss: 0.1dB max.

### Mechanical

Interface: WR-90 (BJ100)  
Flange: FBP100  
Material: Aluminum  
Coating: Black paint

### How To Order

#### QWB-90-U-W-X-Y-Z

U: Angle:  
90 - 90°  
W: H plane: H, E plane: E.  
X: Material  
Y: Flange type  
Z: Serial number if different sizes

Bending Side:  
H - H plane (Outline A)

Material naming rules:  
A - Aluminum (Outline A)

Flange naming rules:  
1 - FBP (Outline A)

Serial number naming rules:  
01 - (Outline A)

Examples:  
To order a waveguide Bends, WR-90, 90°, H plane, Aluminum, FBP100, 50\*50mm, specify QWB-90-90-H-A-1-01.

Customization is available upon request.

### Outline Drawings

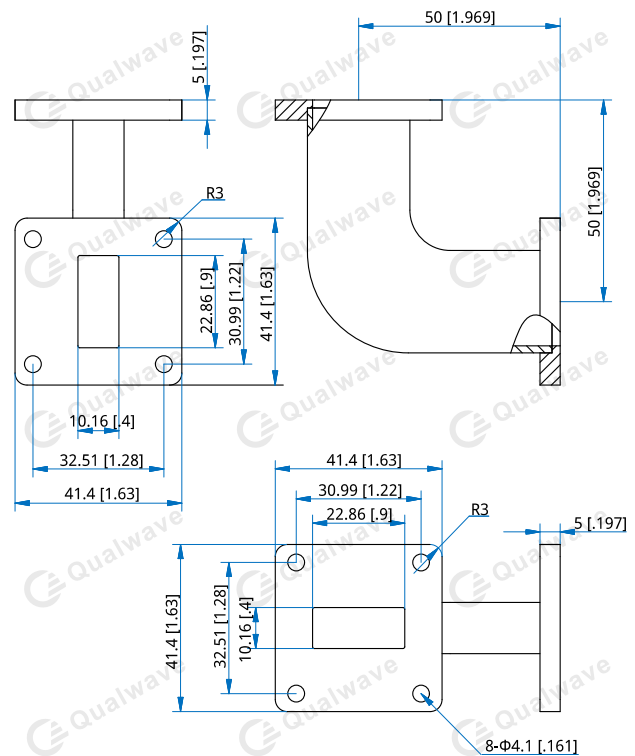

Outline A

Unit: mm [in]  
Tolerance: ±0.5mm [±0.02in]