

# QRJ1-30000-12

## Single Channel, DC~30GHz, 12.5mm

<b>Features:</b>	<b>Applications:</b>
* Low VSWR	* High Speed Digital Signal
* Low VSWR Flatness	Transmission
* Low Insertion Loss Flatness	* Analog Signal Transmission

### Electrical

Frequency:	DC~30GHz
VSWR:	1.35 max.@DC~8GHz
	1.75 max.@DC~18GHz
	2.5 max.@DC~30GHz
VSWR Flatness:	0.15 max.
Insertion Loss:	0.4dB max.@DC~8GHz
	1.0dB max.@DC~18GHz
	2.0dB max.@DC~30GHz
Insertion Loss Flatness:	0.15dB max.
Average Power:	20W max.@18GHz
Phase Flatness:	1.5° max.
Impedance:	50Ω

### Mechanical

Connectors:	3.5mm female
Rotating Speed:	100RPM
Operation Life:	5M Cycles
IP Grade:	IP51

### Environmental

Operating Temperature:	-30~+80°C
Operating Humidity:	0~85%

### Outline Drawings

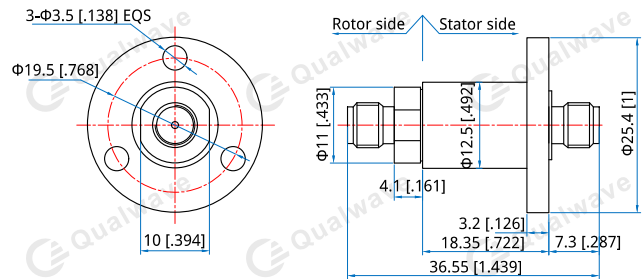

Unit: mm [in]  
Tolerance: ±0.2mm [±0.008in]

### How To Order

**QRJ1-30000-12**

Customization is available upon request.