

QLF-6000-20

500~6000MHz, 20dB

Features:

- * High Stopband Rejection
- * Small Size

Applications:

- * Telecom
- * Laboratory Test
- * Receivers
- * Instrumentation

Electrical

Passband:	500~6000MHz
Passband Insertion Loss:	2dB max.
VSWR:	1.8 max.
Stopband Attenuation:	20dBc@6.5GHz min.

Mechanical

RF Connectors:	SMA Female
Mounting:	4-2.2mm through-hole

Environmental

Operating Temperature:	-40~+70°C
Non-operating Temperature:	-55~+85°C

Outline Drawings

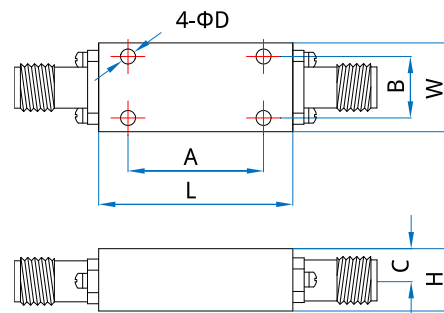

Size	L	W	H	A	B	C	D
mm	37	24	11	28	19	5.5	2.2
in	1.457	0.945	0.433	1.102	0.748	0.217	0.087

Unit: mm [in]

Tolerance: ±0.2mm [±0.008in]

How To Order

QLF-6000-20

Customization is available upon request.