

QLF-25000-40

DC~25GHz, 40dBc, 20W

Features:

- * High Stopband Rejection
- * Small Size

Applications:

- * Telecom
- * Laboratory Test
- * Receivers
- * Instrumentation

Electrical

Passband:	DC~25GHz
Passband Insertion Loss:	2dB max.
Passband Ripple:	±1dB max.
VSWR:	2 typ.
Stopband Attenuation:	40dB@28~30GHz
Average Power:	20W max.

Mechanical

Size ^{*1} :	58*13*11mm 2.283*0.512*0.433in
RF Connectors:	2.92mm Female
Mounting:	4*Φ2.2mm through hole

[1] Exclude connectors.

Environmental

Operating Temperature:	+15~+45°C
------------------------	-----------

Outline Drawings

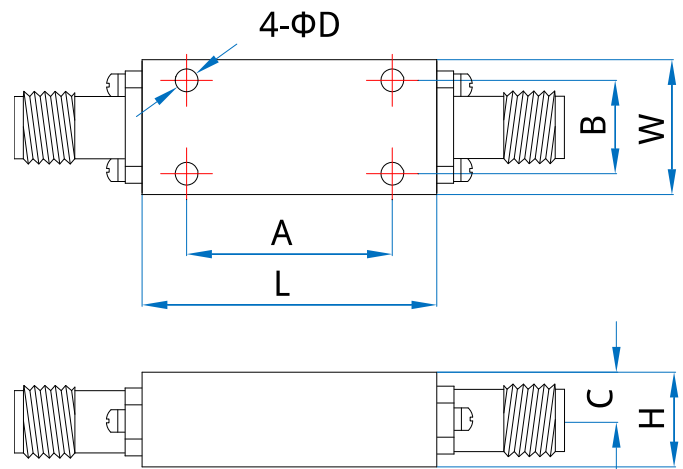

Size	L	W	H	A	B	C	D
mm	58	13	11	25	8	4.9	2.2
in	2.283	0.512	0.433	0.984	0.315	0.193	0.087

Unit: mm [in]

Tolerance: ±0.2mm [±0.008in]

How To Order

QLF-25000-40

Customization is available upon request.