

QASS-A SMA to SMA

Features:
* Low VSWR

Applications:
* Wireless
* Transmitter
* Laboratory Test
* Radar

Electrical

Frequency: DC~26.5GHz
DC~18GHz (Right angle)
VSWR: 1.2 max.
Impedance: 50Ω

Mechanical

RF Connectors: SMA
Mating Life Cycle: 500 cycles
Outer Conductor: Passivated stainless steel
Dielectric: PTFE
Inner Conductor: Gold plated beryllium copper or gold plated brass

How To Order

QASS-MM-A - SMA(m) to SMA(m), Outline A
QASS-MF-A - SMA(m) to SMA(f), Outline B
QASS-FF-A - SMA(f) to SMA(f), Outline C
QASSR-MM-A - SMA(m) to SMA(m) right angle, Outline D
QASSR-MF-A - SMA(m) to SMA(f) right angle, Outline E
QASSH-MF-A - SMA(m) to SMA(f) bulk head, Outline G
QASSH-FF-A - SMA(f) to SMA(f) bulk head, Outline H
QASSL-FF-A - SMA(f) to SMA(f) flange mount, Outline I

Customization is available upon request.

Environmental

Temperature: -55~+85°C

Outline Drawings

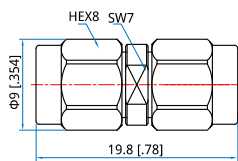

Outline A

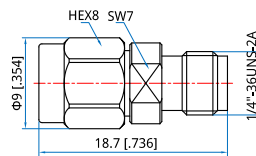

Outline B

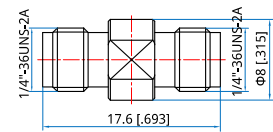

Outline C

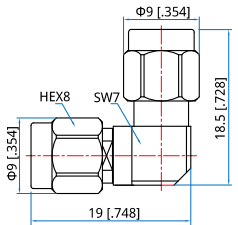

Outline D

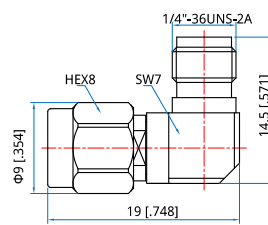

Outline E

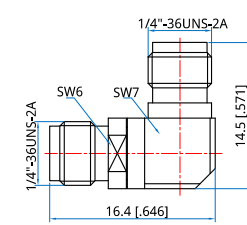

Outline F

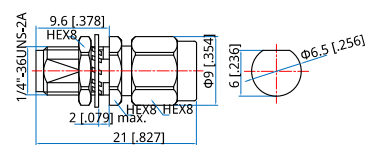

Outline G

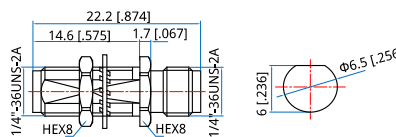

Outline H

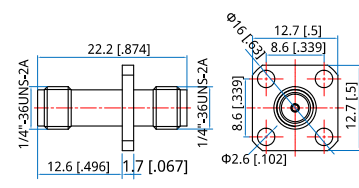

Outline I

Unit: mm [in] Tolerance: ±0.2mm [±0.008in]