

QASQ

SMA to QMA

Features:
* Low VSWR

Applications:
* Wireless
* Transmitter
* Laboratory Test
* Radar

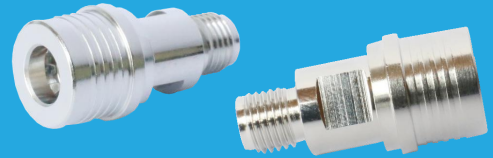

Electrical

Frequency: DC~18GHz
VSWR: 1.15 max.
Impedance: 50Ω

Mechanical

RF Connectors: SMA
QMA
Mating Life Cycle: 5000 cycles
Outer Conductor: SUS303 Stainless Steel
Dielectric: PEI
Inner Conductor: Gold Plated Beryllium Copper

Environmental

Temperature: -60~+165°C

Outline Drawings

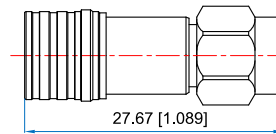

Outline A

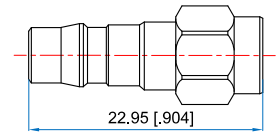

Outline B

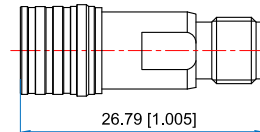

Outline C

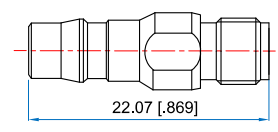

Outline D

Unit: mm [in]

Tolerance: ±0.2mm [±0.008in]

How To Order

QASQ-MM - SMA (m) to QMA (m), Outline A

QASQ-MF - SMA (m) to QMA (f), Outline B

QASQ-FM - SMA (f) to QMA (m), Outline C

QASQ-FF - SMA (f) to QMA (f), Outline D

Customization is available upon request.