

QRF-92-100-50

0.092~0.1GHz, 50dB

Features:

- * High Stopband Rejection
- * Small Size

Applications:

- * Telecom
- * Laboratory Test
- * Receivers
- * Instrumentation

Electrical

Passband:	0.02~0.085GHz
	0.108~2GHz
Passband Insertion Loss:	2.5dB max.
Passband VSWR:	1.5 max.
Stopband:	0.092~0.1GHz
Stopband Attenuation:	50dB min.
Impedance:	50Ω

Mechanical

Size ^{*1} :	25*10*7mm
	0.984*0.394*0.276in
RF Connectors:	Φ0.38 PIN
Mounting:	4-M1.6 through hole

[1] Exclude connectors.

Environmental

Operating Temperature:	-40~+70°C
Non-operating Temperature:	-55~+85°C

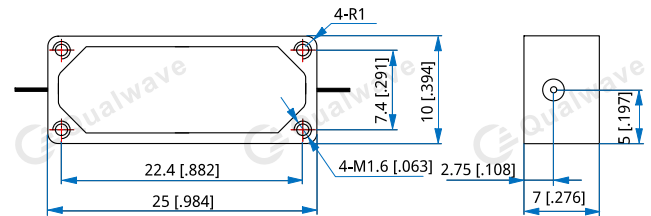
Outline Drawings

Unit: mm [in]

Tolerance: ±0.2mm [±0.008in]

How To Order

QRF-92-100-50

Customization is available upon request.