

## QBF-300-600-30

300~600MHz, 30dB

### Features:

- \* High Stopband Rejection
- \* Small Size

### Applications:

- \* Telecom
- \* Laboratory Test
- \* Receivers
- \* Instrumentation

### Electrical

Passband:	300~600MHz
Passband Insertion Loss:	1.8dB max.
Passband VSWR:	1.5 max.
Stopband Attenuation:	30dBc@260MHz min. 30dBc@650MHz min.

### Mechanical

RF Connectors:	SMA Female
Mounting:	4-M2 through-hole

### Environmental

Operating Temperature:	-45~+85°C
Non-operating Temperature:	-55~+85°C

### Outline Drawings

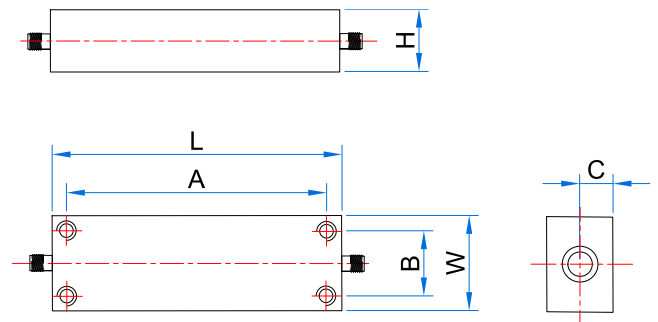

Size	L	W	H	A	B	C
mm	40.4	12	10	37.4	9	5
in	1.591	0.472	0.394	1.472	0.354	0.197

Unit: mm [in]

Tolerance:  $\pm 0.2\text{mm}$  [ $\pm 0.008\text{in}$ ]

### How To Order

**QBF-300-600-30**

Customization is available upon request.